

DLL OSCILLATOR



Specifications

Parameters	Standard	Options
Frequency range	19,440 MHz - 700,0 MHz	
Logic output	LVDS	
Frequency stability		
Overall	+/- 50,0 ppm	+/-15,0 ppm best possible
Initial at 25°C	Please specify	
Temperature		
vs supply voltage change		
vs load change		
Aging first year		
Aging over Years		
Operating temperature	0° C ~ +70°C	-20°C ~ +70°C
		-40°C ~ +85°C
		Other on custom request
Storage temperature	-40°C ~ +85°C	-55°C ~ +125°C
Supply voltage	3,3 V +/-5%	Other on custom request
Current	40 mA max	
Load	100 ohms	
Rise/fall time	1 ns max	Other on custom request
Duty cycle	40/60 %	45/55 %
		Other on custom request
Jitter (12kHz ~20,0 MHz)	< 184,320 MHz : 1ps RMS	Other on custom request
	> 184,320 MHz : 4,5 ps RMS	
Phase noise	Please specify (if required)	
Harmonics		
Sub-harmonics		

DLL OSCILLATOR

Specifications

Parameters	Standard	Options
Start-up time	10 ms max.	Other on custom request
Tristate	High or open = enable Low = disable	no tristate
Marking	Freq + Code + Week +Year	
Package	DIL14 5 pin	DIL14 4 pin

Drawing

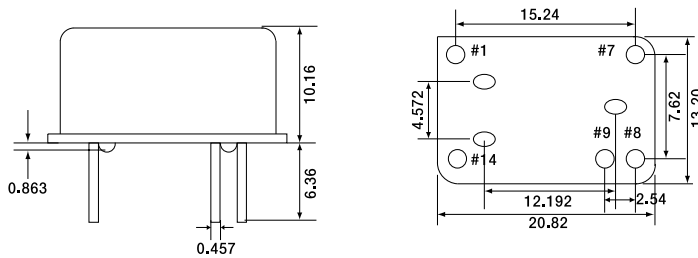

Pin configuration	#1: E/D or NC	other pin configuration possible
	#7 : GND	
	#8 : Output	
	#9 : Complimentary output	
	#14 : Vcc	